

ELECTRICAL SERVICES

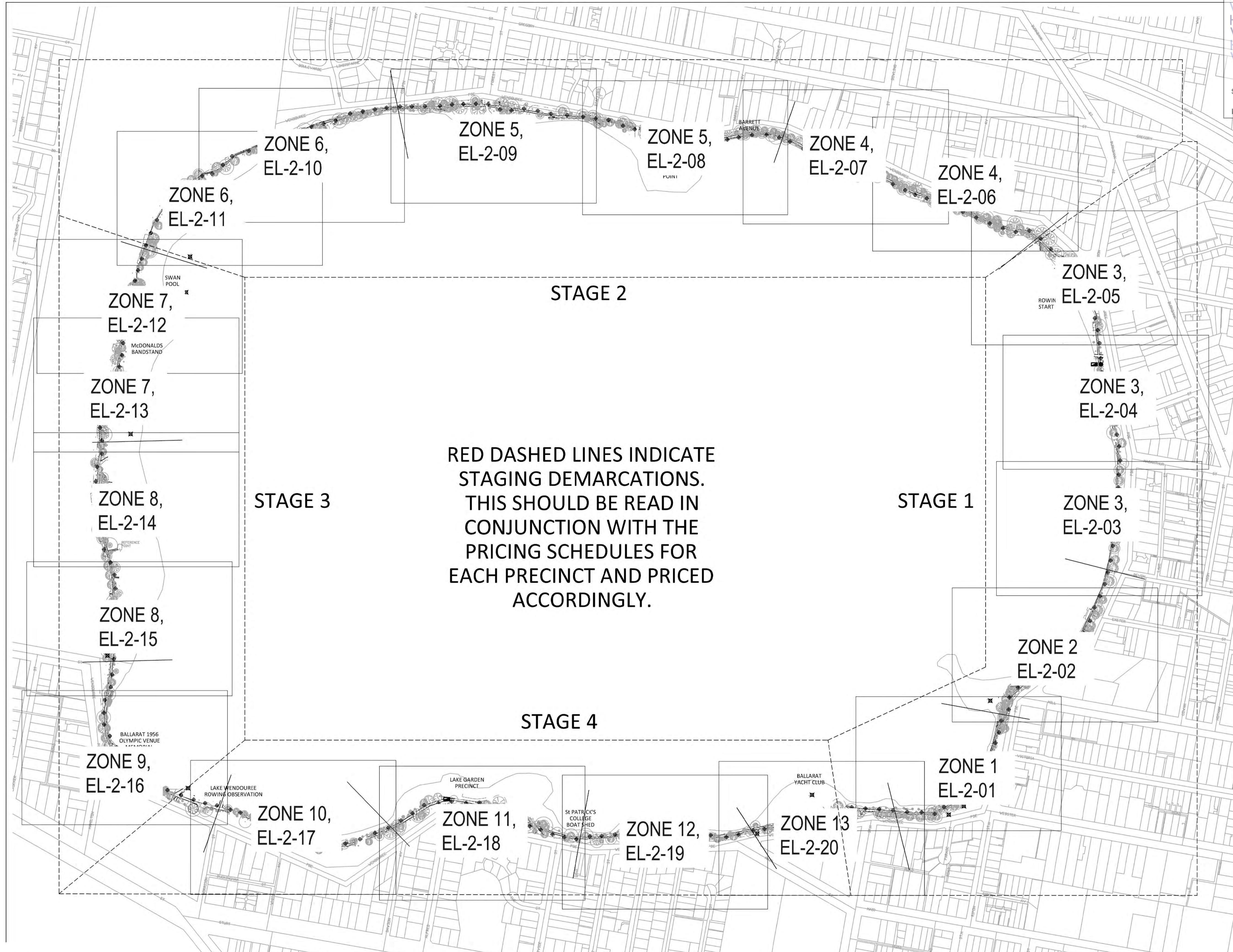

Sheet List Table	
Sheet Number	Sheet Title
EL-0-00	COVER SHEET
EL-0-01	LEGEND AND GENERAL NOTES
EL-1-00	OVERALL TRACK LAYOUT & STAGING PLAN
EL-2-01	ZONE 1 - PROPOSED LIGHTING & POWER LAYOUT - STAGE 1 SHEET 1
EL-2-02	ZONE 2 - PROPOSED LIGHTING & POWER LAYOUT - STAGE 1 SHEET 1
EL-2-03	ZONE 3 - PROPOSED LIGHTING & POWER LAYOUT - STAGE 1 SHEET 1
EL-2-04	ZONE 3 - PROPOSED LIGHTING & POWER LAYOUT - STAGE 1 SHEET 2
EL-2-05	ZONE 3 - PROPOSED LIGHTING & POWER LAYOUT - STAGE 1 SHEET 3
EL-2-06	ZONE 4 - PROPOSED LIGHTING & POWER LAYOUT - STAGE 2 SHEET 1
EL-2-07	ZONE 4 - PROPOSED LIGHTING & POWER LAYOUT - STAGE 2 SHEET 2
EL-2-08	ZONE 5 - PROPOSED LIGHTING & POWER LAYOUT - STAGE 2 SHEET 1
EL-2-09	ZONE 5 - PROPOSED LIGHTING & POWER LAYOUT - STAGE 2 SHEET 2
EL-2-10	ZONE 6 - PROPOSED LIGHTING & POWER LAYOUT - STAGE 2 SHEET 1
EL-2-11	ZONE 6 - PROPOSED LIGHTING & POWER LAYOUT - STAGE 2 SHEET 2
EL-2-12	ZONE 7 - PROPOSED LIGHTING & POWER LAYOUT - STAGE 3 SHEET 1
EL-2-13	ZONE 7 - PROPOSED LIGHTING & POWER LAYOUT - STAGE 3 SHEET 2
EL-2-14	ZONE 8 - PROPOSED LIGHTING & POWER LAYOUT - STAGE 3 SHEET 1
EL-2-15	ZONE 8 - PROPOSED LIGHTING & POWER LAYOUT - STAGE 3 SHEET 2
EL-2-16	ZONE 9 - PROPOSED LIGHTING & POWER LAYOUT - STAGE 3 & STAGE 4 SHEET 1
EL-2-17	ZONE 10 - PROPOSED LIGHTING & POWER LAYOUT - STAGE 4 SHEET 1
EL-2-18	ZONE 11 - PROPOSED LIGHTING & POWER LAYOUT - STAGE 4 SHEET 1
EL-2-19	ZONE 12 - PROPOSED LIGHTING & POWER LAYOUT - STAGE 4 SHEET 1
EL-2-20	ZONE 13 - PROPOSED LIGHTING & POWER LAYOUT - STAGE 4 SHEET 1
EL-9-00	SCHEMATICS & DETAILS - SHEET 1
EL-9-01	SCHEMATICS & DETAILS - SHEET 2
EL-9-02	SCHEMATICS & DETAILS - SHEET 3





RED DASHED LINES INDICATE STAGING DEMARCATIONS. THIS SHOULD BE READ IN CONJUNCTION WITH THE PRICING SCHEDULES FOR EACH PRECINCT AND PRICED ACCORDINGLY.

11. PROJECT ARBORIST WILL REVIEW ON SITE ALL NEW POLE LOCATIONS SHOWING DIRECTIONAL BORING FOR UNDERGROUND CONDUITS IS TO OCCUR AT 100MM DEPTH. 2

UNDERGROUND SERVICES NOTES

- SAND IS TO BE USED ONLY IF THE SOIL EXCAVATED IS, IN THE OPINION OF THE RESPONSIBLE OFFICER, UNSUITABLE FOR BEDDING & SCREENING OF THE CABLES.
- ALL OTHER DEPTH OF TRENCH IS TO BE BACKFILLED WITH EXCAVATED MATERIAL UNLESS OTHERWISE DIRECTED BY THE RESPONSIBLE OFFICER. BACKFILL TO BE COMPACTED & GIVEN TIME TO SETTLE BEFORE REINSTATEMENT OF THE ASPHALT.
- SEPARATION BETWEEN LOW VOLTAGE MAINS CABLES SHOULD BE 50mm.
- ALL DIMENSIONS ARE MINIMUM & APPLY WHEN BACKFILL IS COMPLETE.
- CONDUITS MUST BE OF RIGID HEAVY DUTY CLASS, ORANGE PVC TO A STANDARD NO LESS THAN THAT SPECIFIED IN AS/NZS 2053, OR HEAVY OR MEDIUM GALVANIZED STEEL PIPE TO AS1074.
- UNDERGROUND CABLES BURIED IN ANY PART OF A ROAD RESERVE MUST BE IDENTIFIED BY AN ORANGE WARNING TAPE AT LEAST 150mm ABOVE THE UPPERMOST SURFACE OF THE CABLE OR CONDUIT ENCLLOSING THE CABLE.

WARNING
 BEWARE OF NEW AND EXISTING UNDERGROUND SERVICES

THE LOCATIONS OF NEW AND EXISTING UNDERGROUND SERVICES ARE APPROXIMATE ONLY AND THEIR EXACT POSITION SHOULD BE PROVEN ON SITE. NO GUARANTEE IS GIVEN THAT ALL EXISTING SERVICES ARE SHOWN. IT IS THE CONTRACTOR'S RESPONSIBILITY TO VERIFY LOCATION AND DEPTH OF ALL NEW AND EXISTING UNDERGROUND SERVICES PRIOR TO CONSTRUCTION WORK. THE CONTRACTOR SHALL VISIT THE SITE TO ASCERTAIN THE TRUE NATURE OF THE WORKS. NO CLAIMS FOR EXTRAS WILL BE ALLOWED FOR THROUGH NEGLECT OF THIS ADVICE. COORDINATE INVERT LEVEL AND LOCATION OF NEW AND EXISTING SERVICES TO AVOID CLASHES WITH STRUCTURAL ELEMENTS AND OTHER SERVICES OF OTHER TRADES BEFORE COMMENCING ANY WORK ON SITE.

CONTRACTORS ARE TO PROVIDE A BREAKDOWN OF PRICES FOR EACH OF THE INDICATED STAGING PRECINCTS AS PER THE PRICING SCHEDULE PROVIDED. THE CITY OF BALLARAT RESERVES THE RIGHT TO AWARD THE TENDER ACCORDING TO THESE PRECINCTS, EITHER IN PART OR FOR THE WHOLE SCOPE OF WORKS AS INDICATED ON THE DRAWINGS.

REV	DESCRIPTION	DRAWN	APPD	DATE
2	ISSUED FOR CONSTRUCTION	TRS	JPK	07.06.22
1	ISSUED FOR CONSTRUCTION	TRS	JPK	13.04.22

REPRODUCTION OF DRAWINGS
 THE DRAWINGS HAVE BEEN DOCUMENTED IN COLOUR. AS SUCH, THE DRAWINGS ARE REQUIRED TO BE PRINTED IN COLOUR. FAILURE TO DO SO MAY RESULT IN LOSS OF INFORMATION. BLACK & WHITE PRINTING MAY BE USED IF SPECIFIC BLACK & WHITE DOCUMENTS HAVE BEEN OBTAINED FROM WGE.

CITY OF BALLARAT

ARCHITECT/CIENT

LAKE WENDOUREE, BALLARAT, STEVE MONEGHETTI TRACK
 PUBLIC LIGHTING

OVERALL TRACK LAYOUT & STAGING PLAN

PROJECT TITLE

45683-EL-1-00.dwg

CONSTRUCTION ISSUE

ELECTRICAL SERVICES

Stantec

1:1000 45683 EL-1-00 2

SCALE @ A1 PROJECT No DRAWING No REV

7/06/2022 4:18:44 PM

FOR CONTINUATION REFER TO DRAWING EL-2-02 (ZONE 2 - SHEET 1)

DB	POLES	CIRCUIT	DB	POLES	CIRCUIT
P19.1	105	L1	P17	92	L7
P19.1	106	L1	P17	93	L7
P19.1	107	L1	P17	94	L7
P19.1	108	L1	P17	95	L7
P19.1	109	L2	P17	96	L7
P19.1	110	L2	P17	97	L7
P19.1	111	L2	P17	98	L7
P19.1	112	L2	P17	99	L8
P19.1	113	L2	P17	100	L8
P19.1	114	L2	P17	101	L8
P19.1	115	L2	P17	102	L8
P19.1	116	L2	P17	103	L8
P19.1	117	L2	P17	104	L8

EXISTING P18



EXISTING P17



- SIGNED**
Executive Director
- REFER TO EL-0-01 FOR LEGEND, GENERAL NOTES AND LIGHT FITTING SCHEDULE.
 - POWER AND COMMUNICATION CONDUITS SHALL BE BORED; ENSURE THAT THE REQUIRED CLEARANCE IS MAINTAINED BETWEEN SERVICES.
 - CABLE PITS WITHIN PATHWAYS SHALL BE FINISHED FLUSH WITH THE EXISTING LEVEL OF THE IN-SITU CONCRETE, PAVING OR BITUMEN.
 - ALL CONDUITS SHALL BE SEALED TO PREVENT THE INGRESS OF WATER AFTER INSTALLATION OF CABLING.
 - ALL EQUIPMENT AND ACCESSORIES SHALL BE NEW UNLESS NOTED OTHERWISE.
 - THE ELECTRICAL EQUIPMENT SHOWN ON THE DRAWINGS ARE NOT TO SCALE. FINAL POSITION OF ALL EQUIPMENT TO BE DETERMINED ON SITE PRIOR TO INSTALLATION. REFER TO ARCHITECTURAL FITOUT DRAWINGS.
 - CONDUIT SIZE SHOWN IS REPRESENTATIVE OF THE MINIMUM REQUIREMENT. THE CONTRACTOR MUST SIZE UP TO SUIT THE FINAL CABLE SIZE.
 - CONTRACTOR SHALL ENGAGE WITH TREE ARBORIST TO VALIDATE TPZ (TREE PROTECTION ZONES) WHERE CONDUITS ARE INSTALLED IN CLOSE PROXIMITY AND ADEQUATE PROTECTION SHALL BE PROVIDED TO PREVENT UNDOE DAMAGE TO CONDUITS. EXACT FINAL CONDUIT ROUTES WOULD BE SUBJECT TO SATISFYING ARBORIST REQUIREMENTS.
 - CONTRACTOR SHALL RUN CONDUIT CLOSE TO PATHWAY EDGE. THE CONDUIT RUN DRAWN HERE IS ONLY INDICATIVE. CONTRACTOR TO CONSIDER 500mm BACK OF PATH IN ADDITION TO ABOVE.
 - PROJECT ARBORIST WILL REVIEW ONSITE ALL NEW POLE LOCATIONS SHOWN. DIRECTIONAL BORING FOR UNDERGROUND CONDUITS IS TO OCCUR AT 1000MM DEPTH.

UNDERGROUND SERVICES NOTES

- SAND IS TO BE USED ONLY IF THE SOIL EXCAVATED IS, IN THE OPINION OF THE RESPONSIBLE OFFICER, UNSUITABLE FOR BEDDING & SCREENING OF THE CABLES.
- ALL OTHER DEPTH OF TRENCH IS TO BE BACKFILLED WITH EXCAVATED MATERIAL UNLESS OTHERWISE DIRECTED BY THE RESPONSIBLE OFFICER. BACKFILL TO BE COMPACTED & GIVEN TIME TO SETTLE BEFORE REINSTATEMENT OF THE ASPHALT.
- SEPARATION BETWEEN LOW VOLTAGE MAINS CABLES SHOULD BE 50mm.
- ALL DIMENSIONS ARE MINIMUM & APPLY WHEN BACKFILL IS COMPLETE.
- CONDUITS MUST BE OF RIGID HEAVY DUTY CLASS, ORANGE PVC TO A STANDARD NO LESS THAN THAT SPECIFIED IN AS/NZS 2063, OR HEAVY OR MEDIUM GALVANIZED STEEL PIPE TO AS1074.
- UNDERGROUND CABLES BURIED IN ANY PART OF A ROAD RESERVE MUST BE IDENTIFIED BY AN ORANGE WARNING TAPE AT LEAST 150mm ABOVE THE UPPERMOST SURFACE OF THE CABLE OR CONDUIT ENVELOPING THE CABLE.

WARNING
BEWARE OF NEW AND EXISTING UNDERGROUND SERVICES

THE LOCATIONS OF NEW AND EXISTING UNDERGROUND SERVICES ARE APPROXIMATE ONLY AND THEIR EXACT POSITION SHOULD BE PROVEN ON SITE. NO GUARANTEE IS GIVEN THAT ALL EXISTING SERVICES ARE SHOWN. IT IS THE CONTRACTORS RESPONSIBILITY TO VERIFY LOCATION AND DEPTH OF ALL NEW AND EXISTING UNDERGROUND SERVICES PRIOR TO CONSTRUCTION WORK. THE CONTRACTOR SHALL VISIT THE SITE TO ASCERTAIN THE TRUE NATURE OF THE WORKS. NO CLAIMS FOR EXTRAS WILL BE ALLOWED FOR THROUGH NEGLIGENCE OF THIS ADVICE. COORDINATE INVERT LEVEL AND LOCATION OF NEW AND EXISTING SERVICES TO AVOID CLASHES WITH STRUCTURAL ELEMENTS AND OTHER SERVICES OF OTHER TRADES BEFORE COMMENCING ANY WORK ON SITE.

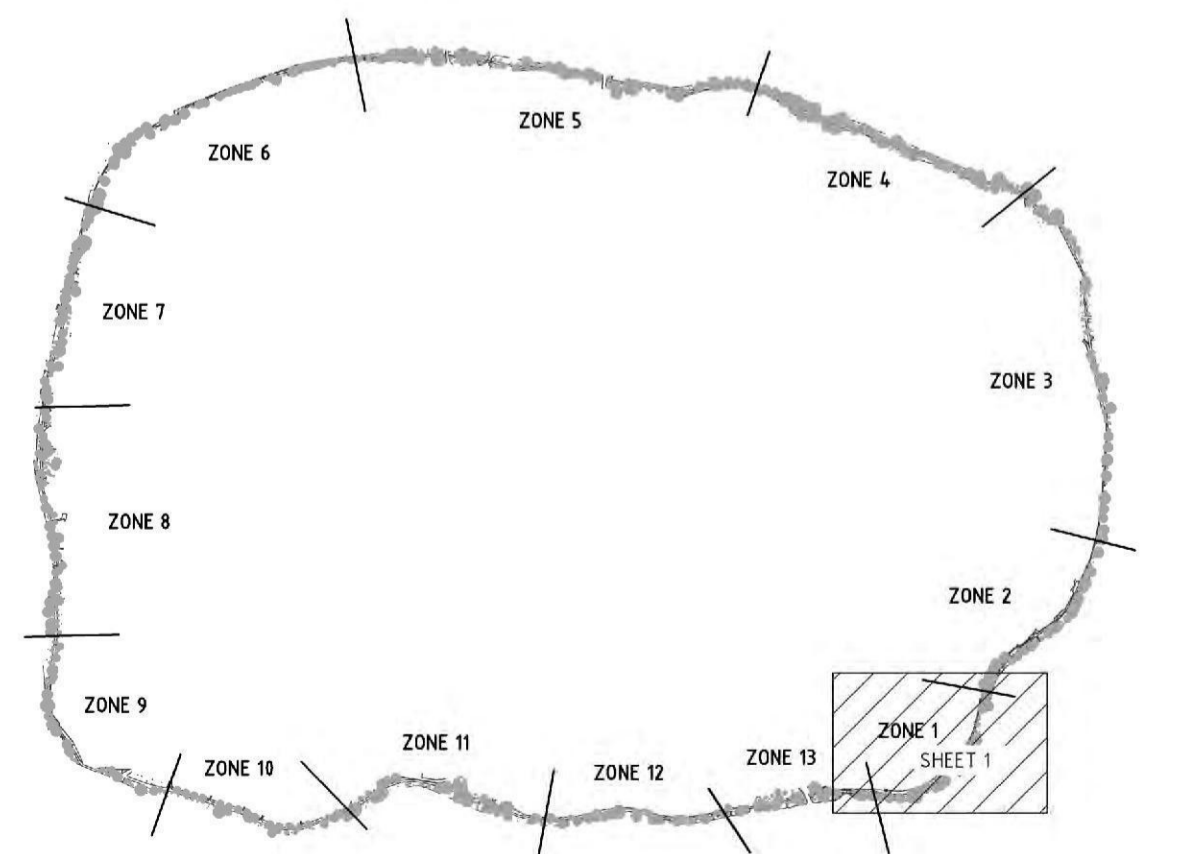

KEY PLAN

FOR CONTINUATION REFER TO DRAWING EL-2-20 (ZONE 13 - SHEET 1)

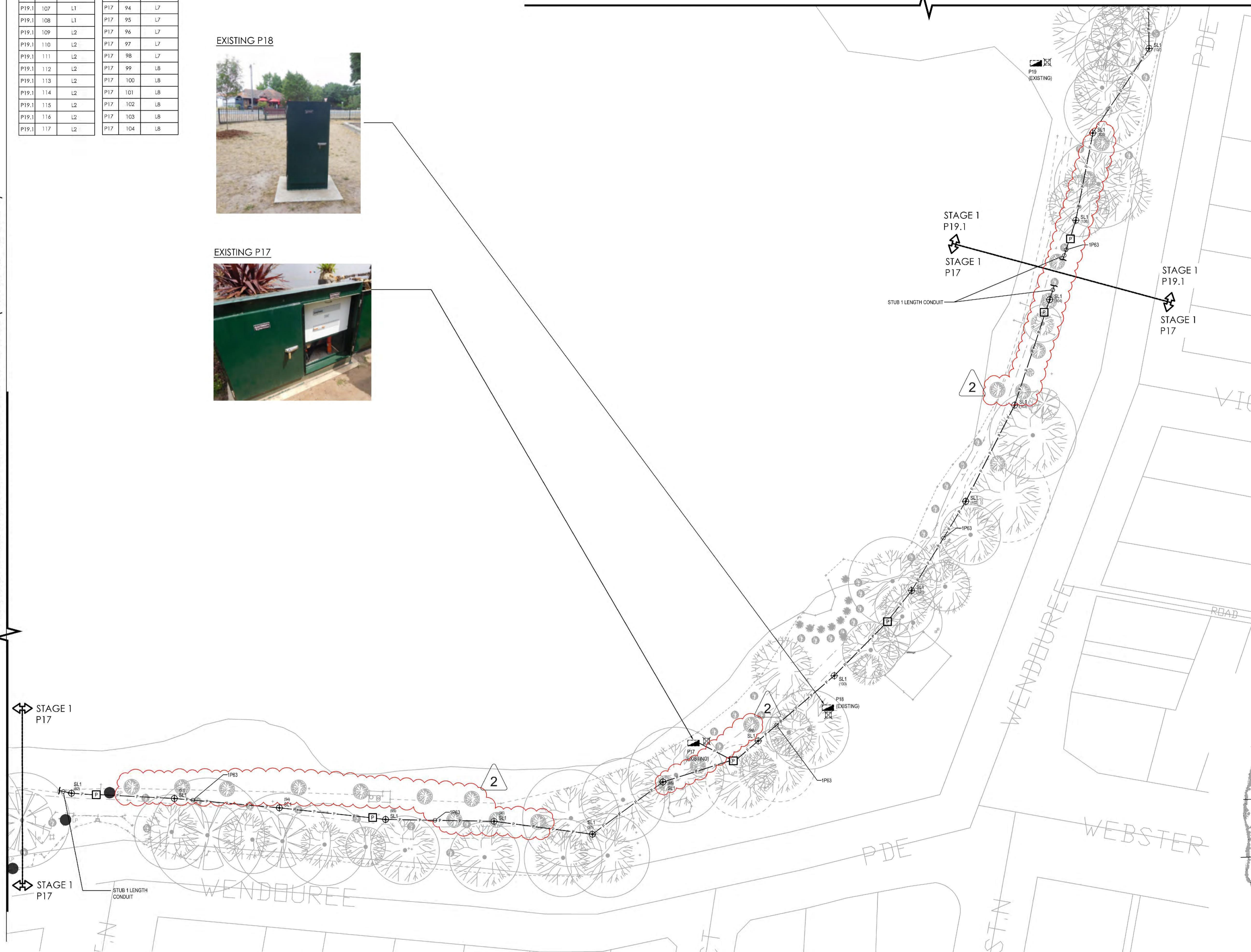

REV	DESCRIPTION	DRAWN	APPD	DATE
2	ISSUED FOR CONSTRUCTION	TRS	JPK	07.06.22
1	ISSUED FOR CONSTRUCTION	TRS	JPK	13.04.22

REPRODUCTION OF DRAWINGS
THE DRAWINGS HAVE BEEN DOCUMENTED IN COLOUR. AS SUCH, THE DRAWINGS ARE REQUIRED TO BE PRINTED IN COLOUR. FAILURE TO DO SO MAY RESULT IN LOSS OF INFORMATION. BLACK & WHITE PRINTING MAY BE USED IF SPECIFIC BLACK & WHITE DOCUMENTS HAVE BEEN OBTAINED FROM WGE.

CITY OF BALLARAT

ARCHITECT/CIENT

LAKE WENDOUREE, BALLARAT,
STEVE MONEGHETTI TRACK
PUBLIC LIGHTING

ZONE 1 - PROPOSED
LIGHTING & POWER LAYOUT -
STAGE 1 SHEET 1

PROJECT TITLE

45683-EL-2-01.dwg

Stantec

CONSTRUCTION ISSUE

ELECTRICAL SERVICES

1:500 45683 EL-2-01 2

SCALE @ A1 PROJECT No DRAWING No REV

7/06/2022 4:25:01 PM

FOR CONTINUATION REFER TO DRAWING EL-2-03 (ZONE 3 - SHEET 1)

DB	POLES	CIRCUIT
P19.1	105	L1
P19.1	106	L1
P19.1	107	L1
P19.1	108	L1
P19.1	109	L2
P19.1	110	L2
P19.1	111	L2
P19.1	112	L2
P19.1	113	L2
P19.1	114	L2
P19.1	115	L2
P19.1	116	L2
P19.1	117	L2

EXISTING OVERHEAD P20

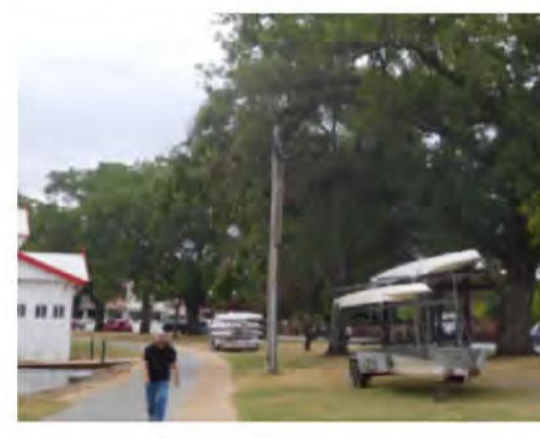

EXISTING P19.1



EXISTING P19



WENDOUREE BALLARAT ROWING CLUB

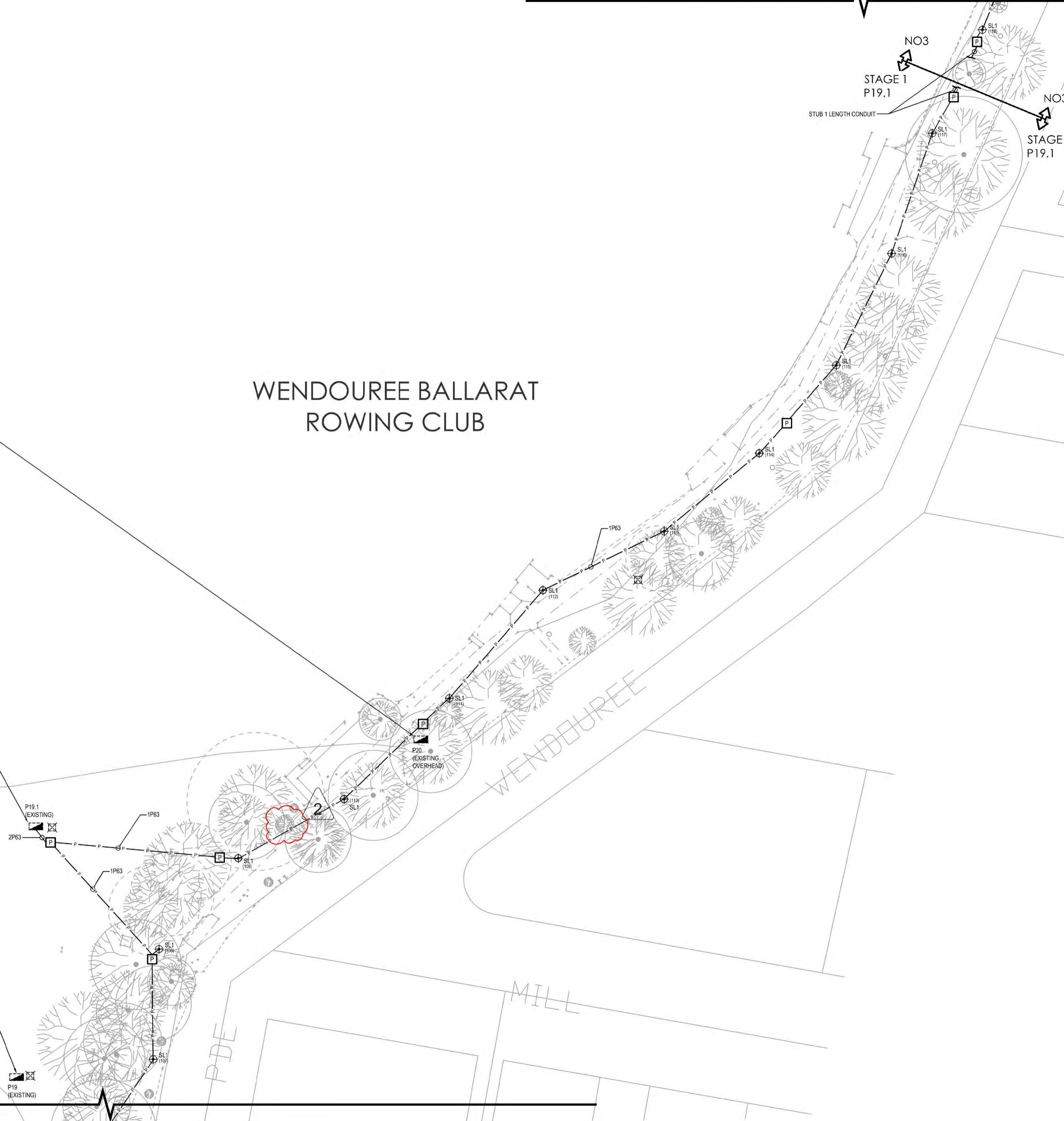

UNDERGROUND SERVICES NOTES

- SAND IS TO BE USED ONLY IF THE SOIL EXCAVATED IS, IN THE OPINION OF THE RESPONSIBLE OFFICER, UNSUITABLE FOR BEDDING & SCREENING OF THE CABLES.
- ALL OTHER DEPTH OF TRENCH IS TO BE BACKFILLED WITH EXCAVATED MATERIAL UNLESS OTHERWISE DIRECTED BY THE RESPONSIBLE OFFICER. BACKFILL TO BE COMPACTED & GIVEN TIME TO SETTLE BEFORE REINSTATEMENT OF THE ASPHALT.
- SEPARATION BETWEEN LOW VOLTAGE MAINS CABLES SHOULD BE 50mm.
- ALL DIMENSIONS ARE MINIMUM & APPLY WHEN BACKFILL IS COMPLETE.
- CONDUITS MUST BE OF RIGID HEAVY DUTY CLASS, ORANGE PVC TO A STANDARD NO LESS THAN THAT SPECIFIED IN AS/NZS 2053, OR HEAVY OR MEDIUM GALVANIZED STEEL PIPE TO AS1074.
- UNDERGROUND CABLES BURIED IN ANY PART OF A ROAD RESERVE MUST BE IDENTIFIED BY AN ORANGE WARNING TAPE AT LEAST 150mm ABOVE THE UPPERMOST SURFACE OF THE CABLE OR CONDUIT ENCLOSED THE CABLE.

WARNING
 BEWARE OF NEW AND EXISTING UNDERGROUND SERVICES
 THE LOCATIONS OF NEW AND EXISTING UNDERGROUND SERVICES ARE APPROXIMATE ONLY AND THEIR EXACT POSITION SHOULD BE PROVEN ON SITE. NO GUARANTEE IS GIVEN THAT ALL EXISTING SERVICES ARE SHOWN. IT IS THE CONTRACTORS RESPONSIBILITY TO VERIFY LOCATION AND DEPTH OF ALL NEW AND EXISTING UNDERGROUND SERVICES PRIOR TO CONSTRUCTION WORK. THE CONTRACTOR SHALL VISIT THE SITE TO ASCERTAIN THE TRUE NATURE OF THE WORKS. NO CLAIMS FOR EXTRAS WILL BE ALLOWED FOR THROUGH NEGLIGENCE OF THIS ADVICE. COORDINATE INVERT LEVEL AND LOCATION OF NEW AND EXISTING SERVICES TO AVOID CLASHES WITH STRUCTURAL ELEMENTS AND OTHER SERVICES OF OTHER TRADES BEFORE COMMENCING ANY WORK ON SITE.

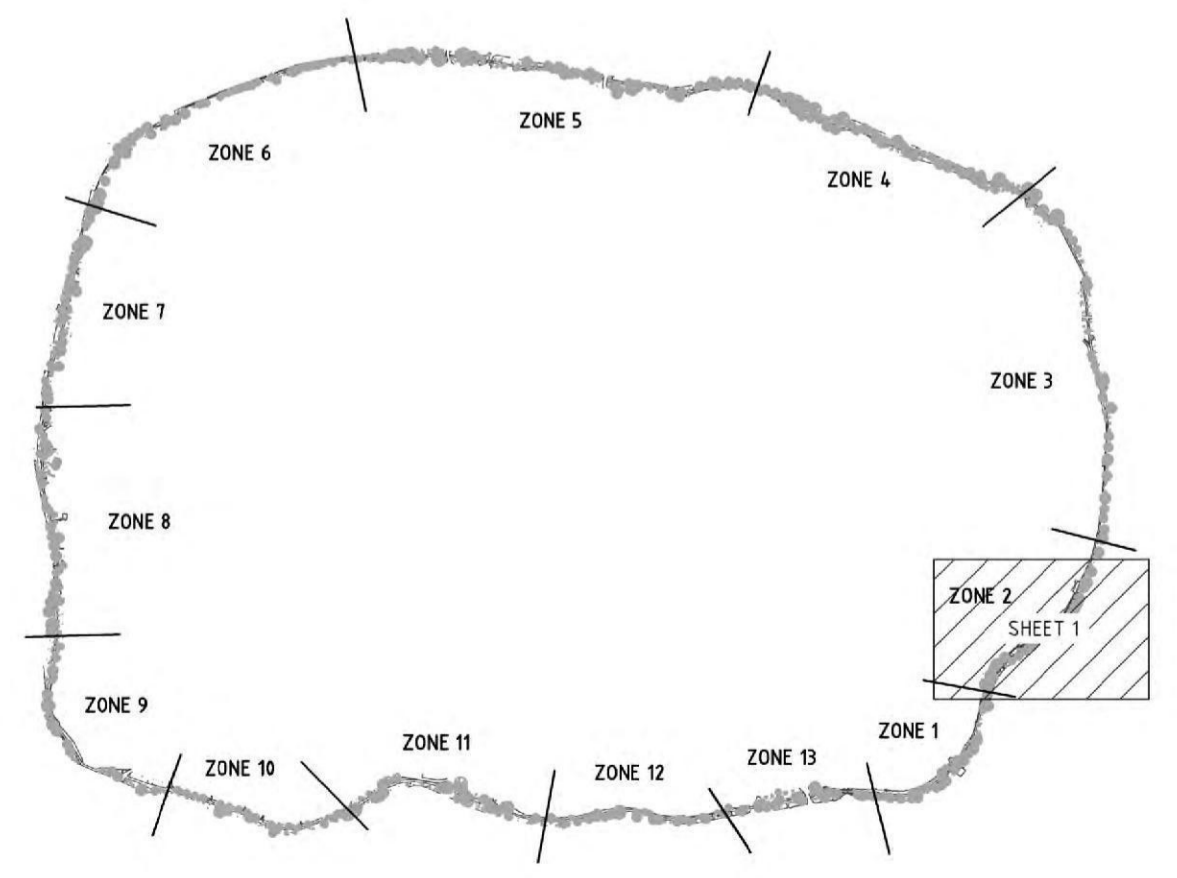

KEY PLAN

FOR CONTINUATION REFER TO DRAWING EL-2-01 (ZONE 1 - SHEET 1)

REV	DESCRIPTION	DRAWN	APPD	DATE
2	ISSUED FOR CONSTRUCTION	TRS	JPK	07.06.22
1	ISSUED FOR CONSTRUCTION	TRS	JPK	13.04.22

REPRODUCTION OF DRAWINGS
 THE DRAWINGS HAVE BEEN DOCUMENTED IN COLOUR. AS SUCH, THE DRAWINGS ARE REQUIRED TO BE PRINTED IN COLOUR. FAILURE TO DO SO MAY RESULT IN LOSS OF INFORMATION. BLACK & WHITE PRINTING MAY BE USED IF SPECIFIC BLACK & WHITE DOCUMENTS HAVE BEEN OBTAINED FROM WGE.

ARCHITECT/CIENT

LAKE WENDOUREE, BALLARAT, STEVE MONEGHETTI TRACK
 PUBLIC LIGHTING

PROJECT

ZONE 2 - PROPOSED LIGHTING & POWER LAYOUT - STAGE 1 SHEET 1

TITLE

45683-EL-2-02.dwg

CONSTRUCTION ISSUE

ELECTRICAL SERVICES

1:500 45683 EL-2-02 2

SCALE @ A1 PROJECT No DRAWING No REV

7/06/2022 4:33:12 PM

FOR CONTINUATION REFER TO DRAWING EL-2-04 (ZONE 3 - SHEET 2)

DB	POLES	CIRCUIT
N03	116	L1
N03	119	L1
N03	120	L1
N03	121	L1
N03	122	L1
N03	123	L1
N03	124	L2
N03	125	L2
N03	126	L2
N03	127	L2
N03	128	L2
N03	129	L2
N03	130	L2
N03	131	L3
N03	132	L3
N03	133	L3

DB	POLES	CIRCUIT
N03	134	L3
N03	135	L3
N03	136	L3
N03	137	L3
N03	138	L3

HERITAGE VICTORIA
HERITAGE VICTORIA
HERITAGE VICTORIA

NOTES

Permit No. P33955
 09/09/2022

VHR No. H2252
 File No. -

Page 6 of 26

2. REFER TO EL-0-01 FOR LEGEND, GENERAL NOTES AND LIGHT FITTING SCHEDULE.

3. POWER AND COMMUNICATION CONDUITS SHALL BE BORED. ENSURE THAT THE MINIMUM REQUIRED CLEARANCE IS MAINTAINED BETWEEN SERVICES.

SIGNED *[Signature]*
Executive Director

NOTE: Conditions apply.



- ALL CONDUITS SHALL BE SEALED TO PREVENT THE INGRESS OF WATER AFTER INSTALLATION OF CABLING.
- ALL EQUIPMENT AND ACCESSORIES SHALL BE NEW UNLESS NOTED OTHERWISE.
- THE ELECTRICAL EQUIPMENT SHOWN ON THE DRAWINGS ARE NOT TO SCALE. FINAL POSITION OF ALL EQUIPMENT TO BE DETERMINED ON SITE PRIOR TO INSTALLATION. REFER TO ARCHITECTURAL FITOUT DRAWINGS.
- CONDUIT SIZE SHOWN IS REPRESENTATIVE OF THE MINIMUM REQUIREMENT. THE CONTRACTOR MUST SIZE UP TO SUIT THE FINAL CABLE SIZE.
- CONTRACTOR SHALL ENGAGE WITH TREE ARBORIST TO VALIDATE TPZ (TREE PROTECTION ZONES) WHERE CONDUITS ARE INSTALLED IN CLOSE PROXIMITY AND ADEQUATE PROTECTION SHALL BE PROVIDED TO PREVENT UNDUE DAMAGE TO CONDUITS. EXACT FINAL CONDUIT ROUTES WOULD BE SUBJECT TO SATISFYING ARBORIST REQUIREMENTS.
- CONTRACTOR SHALL RUN CONDUIT CLOSE TO PATHWAY EDGE. THE CONDUIT RUN DRAWN HERE IS ONLY INDICATIVE. CONTRACTOR TO CONSIDER 50mm BACK OF PATH IN ADDITION TO ABOVE.
- PROJECT ARBORIST WILL REVIEW ONSITE ALL NEW POLE LOCATIONS SHOWN. DIRECTIONAL BORING FOR UNDERGROUND CONDUITS IS TO OCCUR AT 1000MM DEPTH.

UNDERGROUND SERVICES NOTES

- SAND IS TO BE USED ONLY IF THE SOIL EXCAVATED IS, IN THE OPINION OF THE RESPONSIBLE OFFICER, UNSUITABLE FOR BEDDING & SCREENING OF THE CABLES.
- ALL OTHER DEPTH OF TRENCH IS TO BE BACKFILLED WITH EXCAVATED MATERIAL UNLESS OTHERWISE DIRECTED BY THE RESPONSIBLE OFFICER. BACKFILL TO BE COMPACTED & GIVEN TIME TO SETTLE BEFORE REINSTATEMENT OF THE ASPHALT.
- SEPARATION BETWEEN LOW VOLTAGE MAINS CABLES SHOULD BE 50mm.
- ALL DIMENSIONS ARE MINIMUM & APPLY WHEN BACKFILL IS COMPLETE.
- CONDUITS MUST BE OF RIGID HEAVY DUTY CLASS, ORANGE PVC TO A STANDARD NO LESS THAN THAT SPECIFIED IN AS/NZS 2063, OR HEAVY OR MEDIUM GALVANIZED STEEL PIPE TO AS1074.
- UNDERGROUND CABLES BURIED IN ANY PART OF A ROAD RESERVE MUST BE IDENTIFIED BY AN ORANGE WARNING TAPE AT LEAST 150mm ABOVE THE UPPERMOST SURFACE OF THE CABLE OR CONDUIT ENCLOSEING THE CABLE.

WARNING
BEWARE OF NEW AND EXISTING UNDERGROUND SERVICES

THE LOCATIONS OF NEW AND EXISTING UNDERGROUND SERVICES ARE APPROXIMATE ONLY AND THEIR EXACT POSITION SHOULD BE PROVEN ON SITE. NO GUARANTEE IS GIVEN THAT ALL EXISTING SERVICES ARE SHOWN. IT IS THE CONTRACTOR'S RESPONSIBILITY TO VERIFY LOCATION AND DEPTH OF ALL NEW AND EXISTING UNDERGROUND SERVICES PRIOR TO CONSTRUCTION WORK. THE CONTRACTOR SHALL VISIT THE SITE TO ASCERTAIN THE TRUE NATURE OF THE WORKS. NO CLAIMS FOR EXTRAS WILL BE ALLOWED FOR THROUGH NEGLIGENCE OF THIS ADVICE. COORDINATE INVERT LEVEL AND LOCATION OF NEW AND EXISTING SERVICES TO AVOID CLASHES WITH STRUCTURAL ELEMENTS AND OTHER SERVICES OF OTHER TRADES BEFORE COMMENCING ANY WORK ON SITE.

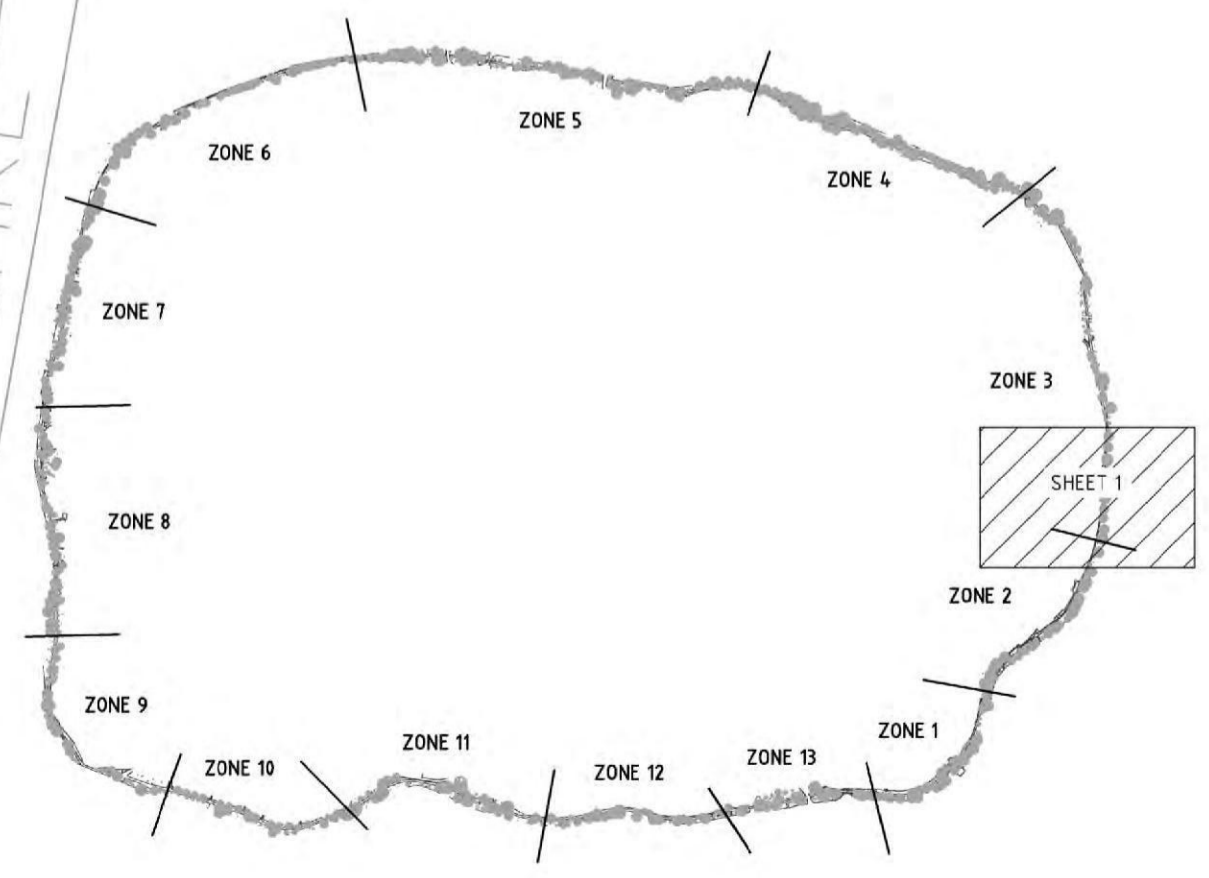

KEY PLAN

FOR CONTINUATION REFER TO DRAWING EL-2-02 (ZONE 2 - SHEET 1)

REV	DESCRIPTION	DRAWN	APPD	DATE
2	ISSUED FOR CONSTRUCTION	TRS	JPK	07.06.22
1	ISSUED FOR CONSTRUCTION	TRS	JPK	13.04.22

REPRODUCTION OF DRAWINGS
 THE DRAWINGS HAVE BEEN DOCUMENTED IN COLOUR. AS SUCH, THE DRAWINGS ARE REQUIRED TO BE PRINTED IN COLOUR. FAILURE TO DO SO MAY RESULT IN LOSS OF INFORMATION. BLACK & WHITE PRINTING MAY BE USED IF SPECIFIC BLACK & WHITE DOCUMENTS HAVE BEEN OBTAINED FROM WGE.

CITY OF BALLARAT

ARCHITECT/CIENT

LAKE WENDOUREE, BALLARAT, STEVE MONEGHETTI TRACK PUBLIC LIGHTING

ZONE 3 - PROPOSED LIGHTING & POWER LAYOUT - STAGE 1 SHEET 1

PROJECT: 45683-EL-2-03.dwg
 TITLE:

CONSTRUCTION ISSUE

Stantec

ELECTRICAL SERVICES

1:500 45683 EL-2-03 2
 SCALE @ A1 PROJECT No DRAWING No REV

FOR CONTINUATION REFER TO DRAWING EL-2-05 (ZONE 3 - SHEET 3)

DB	POLES	CIRCUIT	DB	POLES	CIRCUIT
N03	118	L1	N03	134	L3
N03	119	L1	N03	135	L3
N03	120	L1	N03	136	L3
N03	121	L1	N03	137	L3
N03	122	L1	N03	138	L3
N03	123	L1			
N03	124	L2			
N03	125	L2			
N03	126	L2			
N03	127	L2			
N03	128	L2			
N03	129	L2			
N03	130	L2			
N03	131	L3			
N03	132	L3			
N03	133	L3			

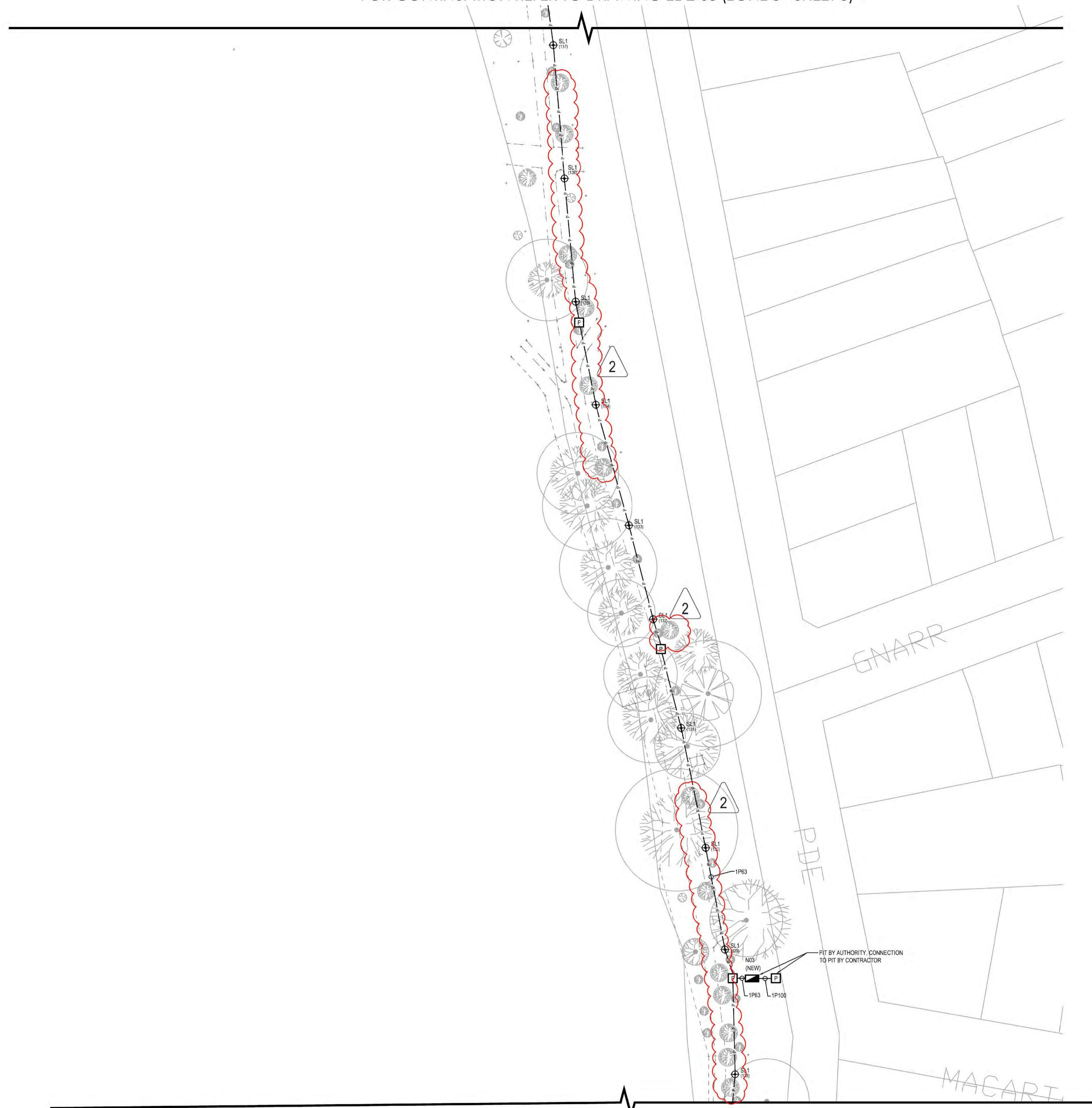

HERITAGE VICTORIA HERITAGE VICTORIA HERITAGE VICTORIA

ENDORSED DOCUMENT
Permit No. P33955
09/09/2022
VHR No. H2252
Page 7 of 26
File No. -

NOTES
1. THIS DRAWING SHALL BE READ IN CONJUNCTION WITH THE ELECTRICAL SERVICES SPECIFICATION NOTES, THE ARCHITECTURAL DRAWINGS AND ALL OTHER RELEVANT SERVICES DRAWINGS.
2. REFER TO EL-0-01 FOR LEGEND, GENERAL NOTES AND LIGHT FITTING SCHEDULE.
3. POWER AND COMMUNICATION CONDUITS SHALL BE BORED. ENSURE THAT THE MINIMUM REQUIRED CLEARANCE IS MAINTAINED BETWEEN SERVICES.

SIGNED: [Signature]
Executive Director

NOTE: Conditions apply.

UNDERGROUND SERVICES NOTES

- SAND IS TO BE USED ONLY IF THE SOIL EXCAVATED IS, IN THE OPINION OF THE RESPONSIBLE OFFICER, UNSUITABLE FOR BEDDING & SCREENING OF THE CABLES.
- ALL OTHER DEPTH OF TRENCH IS TO BE BACKFILLED WITH EXCAVATED MATERIAL UNLESS OTHERWISE DIRECTED BY THE RESPONSIBLE OFFICER. BACKFILL TO BE COMPACTED & GIVEN TIME TO SETTLE BEFORE REINSTATEMENT OF THE ASPHALT.
- SEPARATION BETWEEN LOW VOLTAGE MAINS CABLES SHOULD BE 90mm.
- ALL DIMENSIONS ARE MINIMUM & APPLY WHEN BACKFILL IS COMPLETE.
- CONDUITS MUST BE OF RIGID HEAVY DUTY CLASS, ORANGE PVC TO A STANDARD NO LESS THAN THAT SPECIFIED IN AS/NZS 2063, OR HEAVY OR MEDIUM GALVANIZED STEEL PIPE TO AS1074.
- UNDERGROUND CABLES BURIED IN ANY PART OF A ROAD RESERVE MUST BE IDENTIFIED BY AN ORANGE WARNING TAPE AT LEAST 150mm ABOVE THE UPPERMOST SURFACE OF THE CABLE OR CONDUIT ENCLUSING THE CABLE.

WARNING
BEWARE OF NEW AND EXISTING UNDERGROUND SERVICES

THE LOCATIONS OF NEW AND EXISTING UNDERGROUND SERVICES ARE APPROXIMATE ONLY AND THEIR EXACT POSITION SHOULD BE PROVEN ON SITE. NO GUARANTEE IS GIVEN THAT ALL EXISTING SERVICES ARE SHOWN. IT IS THE CONTRACTORS RESPONSIBILITY TO VERIFY LOCATION AND DEPTH OF ALL NEW AND EXISTING UNDERGROUND SERVICES PRIOR TO CONSTRUCTION WORK. THE CONTRACTOR SHALL VISIT THE SITE TO ASCERTAIN THE TRUE NATURE OF THE WORKS. NO CLAIMS FOR EXTRAS WILL BE ALLOWED FOR THROUGH NEGLIGENCE OF THIS ADVICE. COORDINATE INVERT LEVEL AND LOCATION OF NEW AND EXISTING SERVICES TO AVOID CLASHES WITH STRUCTURAL ELEMENTS AND OTHER SERVICES OF OTHER TRADES BEFORE COMMENCING ANY WORK ON SITE.

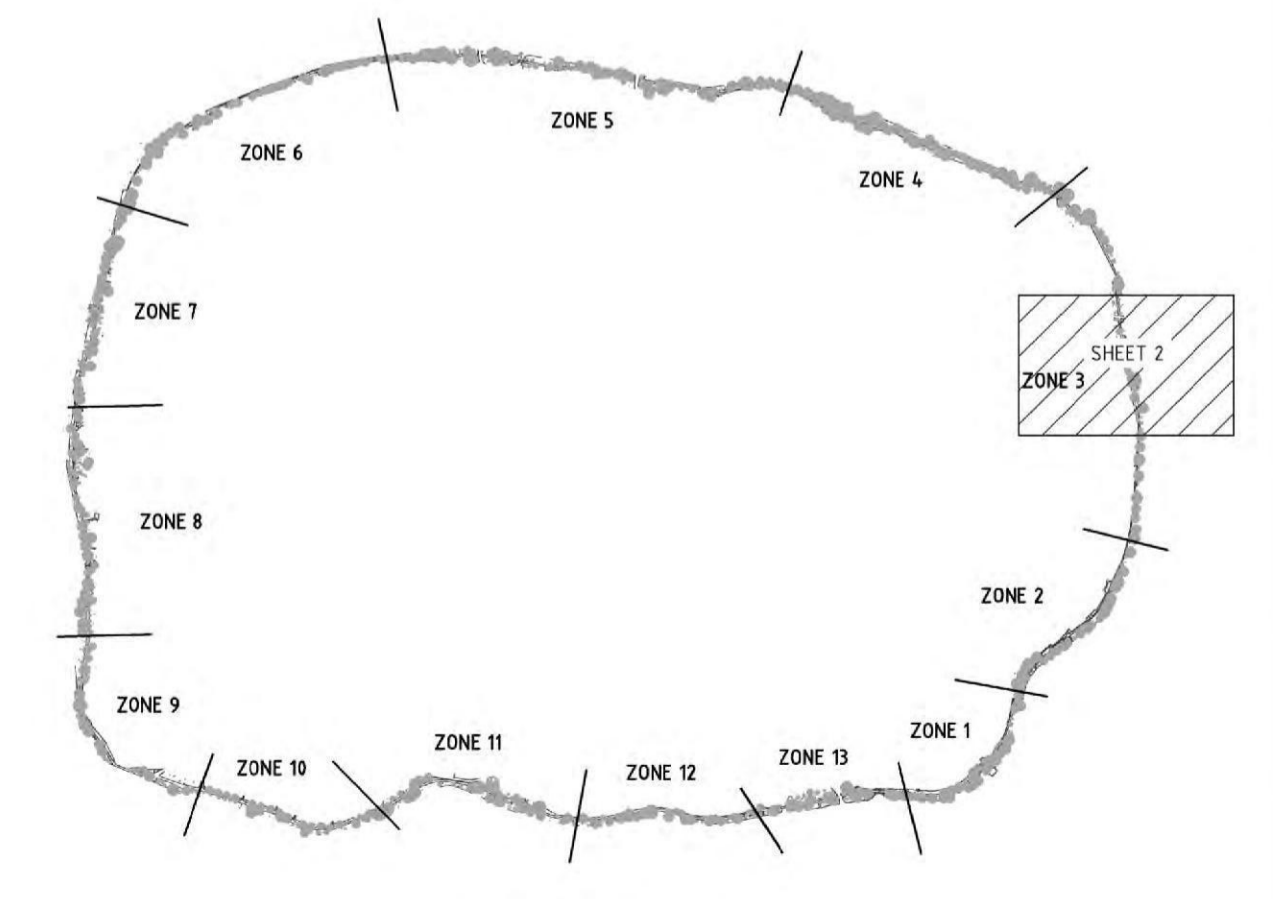

FOR CONTINUATION REFER TO DRAWING EL-2-03 (ZONE 3 - SHEET 1)

REV	DESCRIPTION	DRAWN	APPD	DATE
2	ISSUED FOR CONSTRUCTION	TRS	JPK	07.06.22
1	ISSUED FOR CONSTRUCTION	TRS	JPK	13.04.22

REPRODUCTION OF DRAWINGS
THE DRAWINGS HAVE BEEN DOCUMENTED IN COLOUR. AS SUCH, THE DRAWINGS ARE REQUIRED TO BE PRINTED IN COLOUR. FAILURE TO DO SO MAY RESULT IN LOSS OF INFORMATION. BLACK & WHITE PRINTING MAY BE USED IF SPECIFIC BLACK & WHITE DOCUMENTS HAVE BEEN OBTAINED FROM WGE.

CITY OF BALLARAT

ARCHITECT/CIENT

LAKE WENDOUREE, BALLARAT, STEVE MONEGHETTI TRACK PUBLIC LIGHTING

ZONE 3 - PROPOSED LIGHTING & POWER LAYOUT - STAGE 1 SHEET 2

PROJECT: 45683-EL-2-04.dwg
TITLE: 45683-EL-2-04.dwg

Stantec

CONSTRUCTION ISSUE

ELECTRICAL SERVICES

1:500 45683 EL-2-04 2
SCALE @ A1 PROJECT No DRAWING No REV

7/06/2022 4:40:48 PM

FOR CONTINUATION REFER TO DRAWING EL-2-06 (ZONE 4 - SHEET 1)

HERITAGE VICTORIA HERITAGE VICTORIA HERITAGE VIC

Permit No. P33955

09/09/2022

VHR No. H2252

Page 3 of 26

File No. -

NOTES

- THIS DRAWING SHALL BE REVIEWED BY THE ELECTRICAL SERVICES SPECIFICATION NOTES, THE ARCHITECTURAL DRAWINGS AND ALL OTHER RELEVANT SERVICES DRAWINGS.
- REFER TO EL-0-01 FOR LEGEND, GENERAL NOTES AND LIGHT FITTING SCHEDULE.
- POWER AND COMMUNICATION CONDUITS SHALL BE BORED. ENSURE THAT THE MINIMUM REQUIRED CLEARANCE IS MAINTAINED BETWEEN SERVICES.
- CABLES WITHIN PATHWAYS SHALL BE FINISHED FLUSH WITH THE FINISHED LEVEL OF THE IN-SITU CONCRETE, PAVING OR BITUMEN.
- ALL CONDUITS SHALL BE SEALED TO PREVENT THE INGRESS OF WATER AFTER INSTALLATION OF CABLING.
- ALL EQUIPMENT AND ACCESSORIES SHALL BE NEW UNLESS NOTED OTHERWISE.
- THE ELECTRICAL EQUIPMENT SHOWN ON THE DRAWINGS ARE NOT TO SCALE. FINAL POSITION OF ALL EQUIPMENT TO BE DETERMINED ON SITE PRIOR TO INSTALLATION. REFER TO ARCHITECTURAL FITOUT DRAWINGS.
- CONDUIT SIZE SHOWN IS REPRESENTATIVE OF THE MINIMUM REQUIREMENT. THE CONTRACTOR MUST SIZE UP TO SUIT THE FINAL CABLE SIZE.
- CONTRACTOR SHALL ENGAGE WITH TREE ARBORIST TO VALIDATE TPZ (TREE PROTECTION ZONES) WHERE CONDUITS ARE INSTALLED IN CLOSE PROXIMITY AND ADEQUATE PROTECTION SHALL BE PROVIDED TO PREVENT UNDUE DAMAGE TO CONDUITS. EXACT FINAL CONDUIT ROUTES WOULD BE SUBJECT TO SATISFYING ARBORIST REQUIREMENTS.
- CONTRACTOR SHALL RUN CONDUIT CLOSE TO PATHWAY EDGE. THE CONDUIT RUN DRAWN HERE IS ONLY INDICATIVE. CONTRACTOR TO CONSIDER 500mm BACK OF PATH IN ADDITION TO ABOVE.
- PROJECT ARBORIST WILL REVIEW ON SITE ALL NEW POLE LOCATIONS SHOWN. DIRECTIONAL BORING FOR UNDERGROUND CONDUITS IS TO OCCUR AT 1000MM DEPTH.

SIGNED: *[Signature]*

Executive Director

NOTE: Conditions apply.

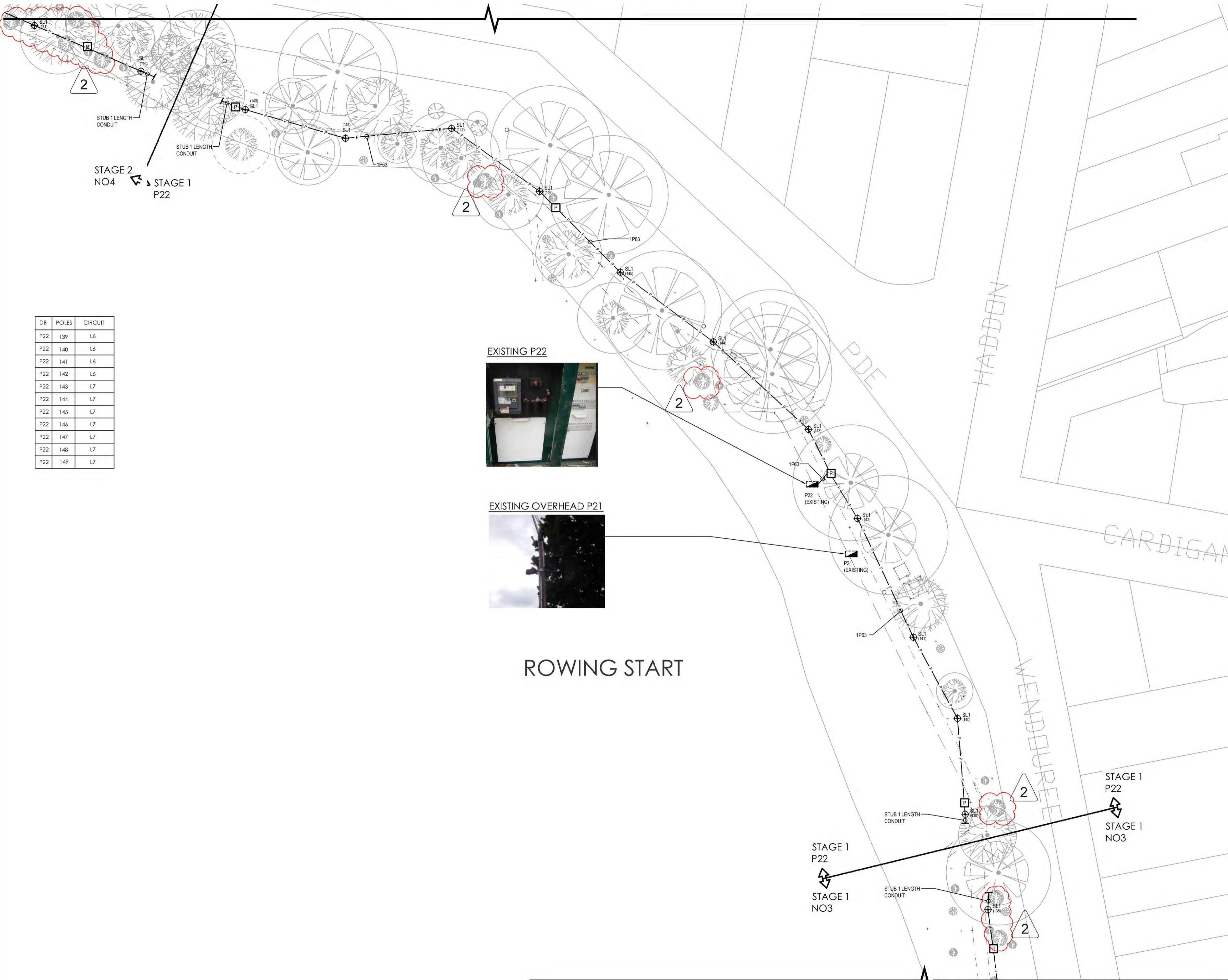

DB	POLES	CIRCUIT
P22	139	L6
P22	140	L6
P22	141	L6
P22	142	L6
P22	143	L7
P22	144	L7
P22	145	L7
P22	146	L7
P22	147	L7
P22	148	L7
P22	149	L7



UNDERGROUND SERVICES NOTES

- SAND IS TO BE USED ONLY IF THE SOIL EXCAVATED IS, IN THE OPINION OF THE RESPONSIBLE OFFICER, UNSUITABLE FOR BEDDING & SCREENING OF THE CABLES.
- ALL OTHER DEPTH OF TRENCH IS TO BE BACKFILLED WITH EXCAVATED MATERIAL UNLESS OTHERWISE DIRECTED BY THE RESPONSIBLE OFFICER. BACKFILL TO BE COMPACTED & GIVEN TIME TO SETTLE BEFORE REINSTATEMENT OF THE ASPHALT.
- SEPARATION BETWEEN LOW VOLTAGE MAINS CABLES SHOULD BE 50mm.
- ALL DIMENSIONS ARE MINIMUM & APPLY WHEN BACKFILL IS COMPLETE.
- CONDUITS MUST BE OF RIGID HEAVY DUTY CLASS, ORANGE PVC TO A STANDARD NO LESS THAN THAT SPECIFIED IN AS/NZS 2053 OR HEAVY OR MEDIUM GALVANIZED STEEL PIPE TO AS1074.
- UNDERGROUND CABLES BURIED IN ANY PART OF A ROAD RESERVE MUST BE IDENTIFIED BY AN ORANGE WARNING TAPE AT LEAST 150mm ABOVE THE UPPERMOST SURFACE OF THE CABLE OR CONDUIT ENCLOSING THE CABLE.

WARNING

BEWARE OF NEW AND EXISTING UNDERGROUND SERVICES

THE LOCATIONS OF NEW AND EXISTING UNDERGROUND SERVICES ARE APPROXIMATE ONLY AND THEIR EXACT POSITION SHOULD BE PROVEN ON SITE. NO GUARANTEE IS GIVEN THAT ALL EXISTING SERVICES ARE SHOWN. IT IS THE CONTRACTORS RESPONSIBILITY TO VERIFY LOCATION AND DEPTH OF ALL NEW AND EXISTING UNDERGROUND SERVICES PRIOR TO CONSTRUCTION WORK. THE CONTRACTOR SHALL VISIT THE SITE TO ASCERTAIN THE TRUE NATURE OF THE WORKS. NO CLAIMS FOR EXTRAS WILL BE ALLOWED FOR THROUGH NEGLIGENCE OF THIS ADVICE. COORDINATE INVERT LEVEL AND LOCATION OF NEW AND EXISTING SERVICES TO AVOID CLASHES WITH STRUCTURAL ELEMENTS AND OTHER SERVICES OF OTHER TRADES BEFORE COMMENCING ANY WORK ON SITE.

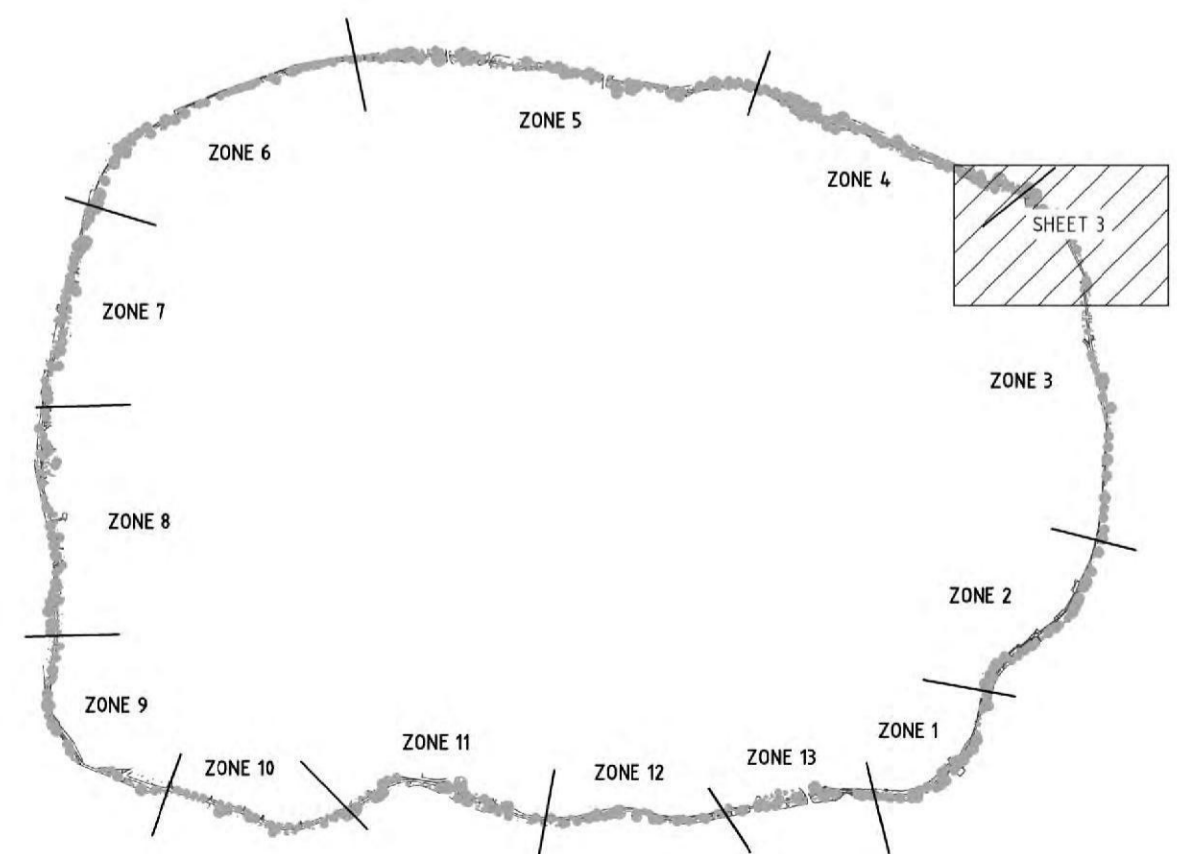

FOR CONTINUATION REFER TO DRAWING EL-2-04 (ZONE 3 - SHEET 2)

REV	DESCRIPTION	DRAWN	APPD	DATE
2	ISSUED FOR CONSTRUCTION	TRS	JPK	07.06.22
1	ISSUED FOR CONSTRUCTION	TRS	JPK	13.04.22

REPRODUCTION OF DRAWINGS

THE DRAWINGS HAVE BEEN DOCUMENTED IN COLOUR. AS SUCH, THE DRAWINGS ARE REQUIRED TO BE PRINTED IN COLOUR. FAILURE TO DO SO MAY RESULT IN LOSS OF INFORMATION. BLACK & WHITE PRINTING MAY BE USED IF SPECIFIC BLACK & WHITE DOCUMENTS HAVE BEEN OBTAINED FROM WGE.

ARCHITECT/CIENT

LAKE WENDOUREE, BALLARAT, STEVE MONEGHETTI TRACK PUBLIC LIGHTING

ZONE 3 - PROPOSED LIGHTING & POWER LAYOUT - STAGE 1 SHEET 3

PROJECT: 45683-EL-2-05.dwg

TITLE

CONSTRUCTION ISSUE

ELECTRICAL SERVICES

Stantec

1:500 45683 EL-2-05 2

SCALE @ A1 PROJECT No DRAWING No REV

7/06/2022 4:43:18 PM

FOR CONTINUATION REFER TO DRAWING EL-2-07 (ZONE 4 - SHEET 2)

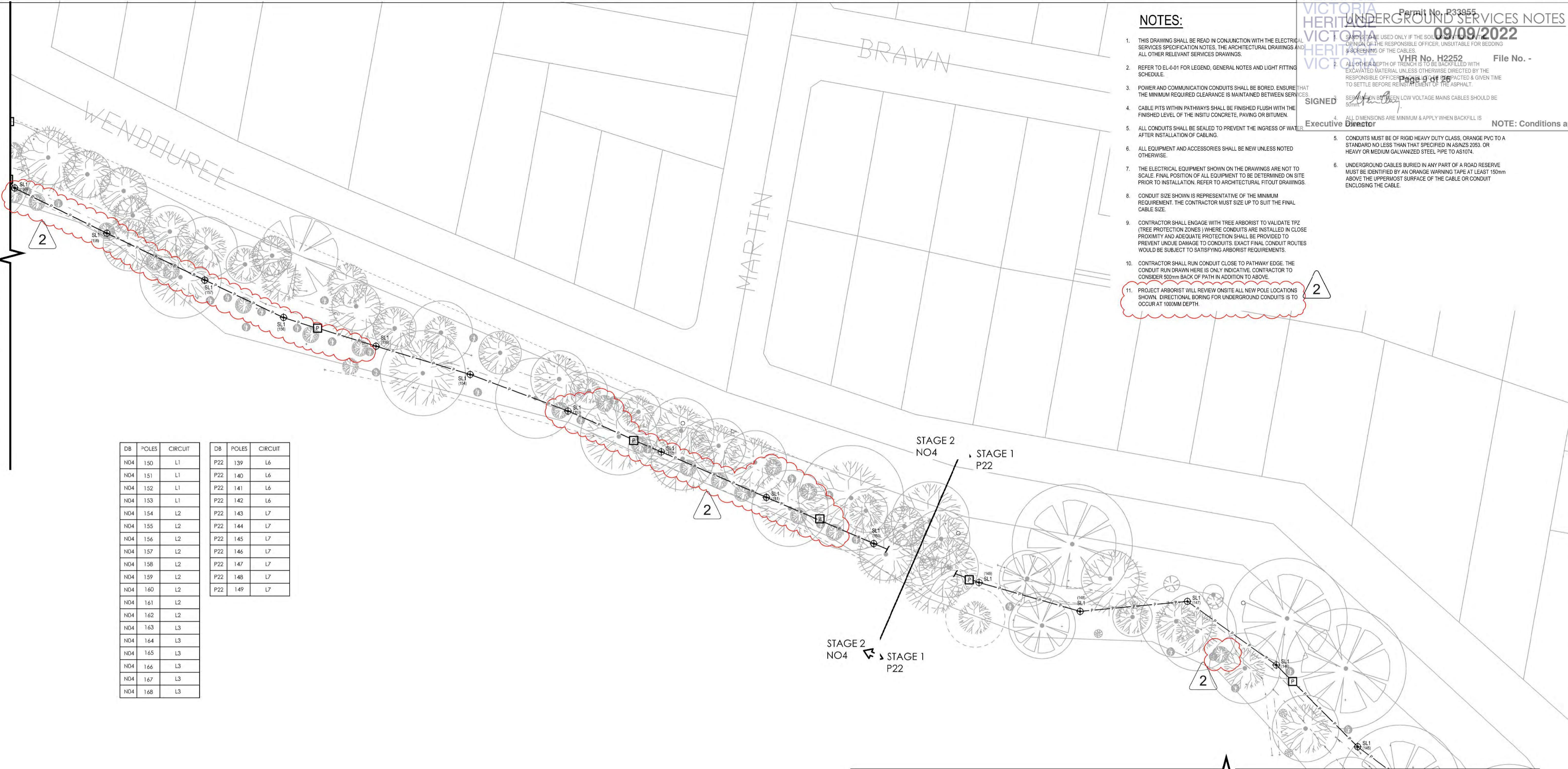

NOTES:

- THIS DRAWING SHALL BE READ IN CONJUNCTION WITH THE ELECTRICAL SERVICES SPECIFICATION NOTES, THE ARCHITECTURAL DRAWINGS AND ALL OTHER RELEVANT SERVICES DRAWINGS.
- REFER TO EL-0-01 FOR LEGEND, GENERAL NOTES AND LIGHT FITTING SCHEDULE.
- POWER AND COMMUNICATION CONDUITS SHALL BE BORED. ENSURE THAT THE MINIMUM REQUIRED CLEARANCE IS MAINTAINED BETWEEN SERVICES.
- CABLE PITS WITHIN PATHWAYS SHALL BE FINISHED FLUSH WITH THE FINISHED LEVEL OF THE INSITU CONCRETE, PAVING OR BITUMEN.
- ALL CONDUITS SHALL BE SEALED TO PREVENT THE INGRESS OF WATER AFTER INSTALLATION OF CABLING.
- ALL EQUIPMENT AND ACCESSORIES SHALL BE NEW UNLESS NOTED OTHERWISE.
- THE ELECTRICAL EQUIPMENT SHOWN ON THE DRAWINGS ARE NOT TO SCALE. FINAL POSITION OF ALL EQUIPMENT TO BE DETERMINED ON SITE PRIOR TO INSTALLATION. REFER TO ARCHITECTURAL FITOUT DRAWINGS.
- CONDUIT SIZE SHOWN IS REPRESENTATIVE OF THE MINIMUM REQUIREMENT. THE CONTRACTOR MUST SIZE UP TO SUIT THE FINAL CABLE SIZE.
- CONTRACTOR SHALL ENGAGE WITH TREE ARBORIST TO VALIDATE TPZ (TREE PROTECTION ZONES) WHERE CONDUITS ARE INSTALLED IN CLOSE PROXIMITY AND ADEQUATE PROTECTION SHALL BE PROVIDED TO PREVENT UNDEIR DAMAGE TO CONDUITS EXACT FINAL CONDUIT ROUTES WOULD BE SUBJECT TO SATISFYING ARBORIST REQUIREMENTS.
- CONTRACTOR SHALL RUN CONDUIT CLOSE TO PATHWAY EDGE. THE CONDUIT RUN DRAWN HERE IS ONLY INDICATIVE. CONTRACTOR TO CONSIDER 500mm BACK OF PATH IN ADDITION TO ABOVE.
- PROJECT ARBORIST WILL REVIEW ONSITE ALL NEW POLE LOCATIONS SHOWN. DIRECTIONAL BORING FOR UNDERGROUND CONDUITS IS TO OCCUR AT 1000MM DEPTH.

HERITAGE VICTORIA
 UNDERGROUND SERVICES NOTES
 Permit No. P33955
 09/09/2022
 VHR No. H2252
 File No. -
 Page 1 of 26
 SIGNED: [Signature]
 Executive Director
 NOTE: Conditions apply.

DB	POLES	CIRCUIT	DB	POLES	CIRCUIT
ND4	150	L1	P22	139	L6
ND4	151	L1	P22	140	L6
ND4	152	L1	P22	141	L6
ND4	153	L1	P22	142	L6
ND4	154	L2	P22	143	L7
ND4	155	L2	P22	144	L7
ND4	156	L2	P22	145	L7
ND4	157	L2	P22	146	L7
ND4	158	L2	P22	147	L7
ND4	159	L2	P22	148	L7
ND4	160	L2	P22	149	L7
ND4	161	L2			
ND4	162	L2			
ND4	163	L3			
ND4	164	L3			
ND4	165	L3			
ND4	166	L3			
ND4	167	L3			
ND4	168	L3			

FOR CONTINUATION REFER TO DRAWING EL-2-05 (ZONE 3 - SHEET 3)

WARNING
 BEWARE OF NEW AND EXISTING UNDERGROUND SERVICES

THE LOCATIONS OF NEW AND EXISTING UNDERGROUND SERVICES ARE APPROXIMATE ONLY AND THEIR EXACT POSITION SHOULD BE PROVEN ON SITE. NO GUARANTEE IS GIVEN THAT ALL EXISTING SERVICES ARE SHOWN. IT IS THE CONTRACTORS RESPONSIBILITY TO VERIFY LOCATION AND DEPTH OF ALL NEW AND EXISTING UNDERGROUND SERVICES PRIOR TO CONSTRUCTION WORK. THE CONTRACTOR SHALL VISIT THE SITE TO ASCERTAIN THE TRUE NATURE OF THE WORKS. NO CLAIMS FOR EXTRAS WILL BE ALLOWED FOR THROUGH NEGLIGENCE OF THIS ADVICE. COORDINATE INVERT LEVEL AND LOCATION OF NEW AND EXISTING SERVICES TO AVOID CLASHES WITH STRUCTURAL ELEMENTS AND OTHER SERVICES OF OTHER TRADES BEFORE COMMENCING ANY WORK ON SITE.

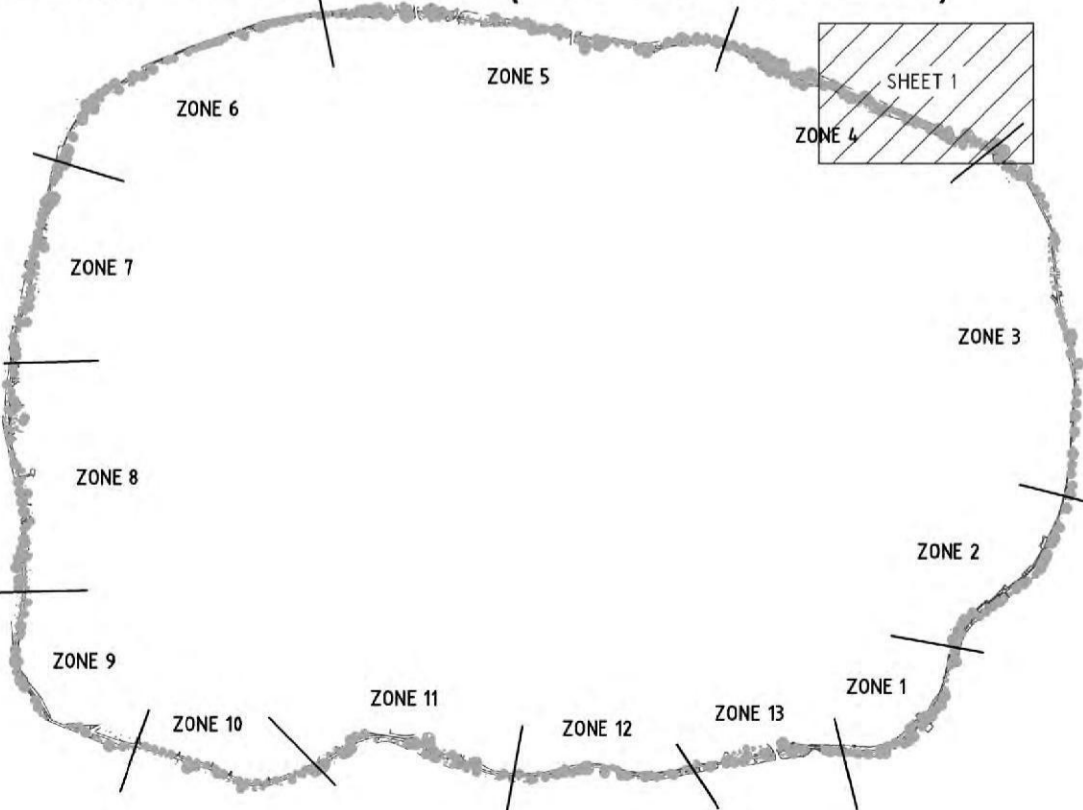

KEY PLAN

REV	DESCRIPTION	DRAWN	APPD	DATE
2	ISSUED FOR CONSTRUCTION	TRS	JPK	07.06.22
1	ISSUED FOR CONSTRUCTION	TRS	JPK	13.04.22

REPRODUCTION OF DRAWINGS
 THE DRAWINGS HAVE BEEN DOCUMENTED IN COLOUR. AS SUCH, THE DRAWINGS ARE REQUIRED TO BE PRINTED IN COLOUR. FAILURE TO DO SO MAY RESULT IN LOSS OF INFORMATION. BLACK & WHITE PRINTING MAY BE USED IF SPECIFIC BLACK & WHITE DOCUMENTS HAVE BEEN OBTAINED FROM WGE.

CITY OF BALLARAT

ARCHITECT/CIENT

LAKE WENDOUREE, BALLARAT,
 STEVE MONEGHETTI TRACK
 PUBLIC LIGHTING

ZONE 4 - PROPOSED
 LIGHTING & POWER LAYOUT -
 STAGE 2 SHEET 1

PROJECT TITLE

45683-EL-2-06.dwg

CONSTRUCTION ISSUE

Stantec

1:500 45683 EL-2-06 2

SCALE @ A1 PROJECT No DRAWING No REV

7/06/2022 4:45:04 PM

FOR CONTINUATION REFER TO DRAWING EL-2-08 (ZONE 5 - SHEET 1)

VENUE



- NOTES:**
- THIS DRAWING SHALL BE READ IN CONJUNCTION WITH THE ELECTRICAL SERVICES SPECIFICATION NOTES, THE ARCHITECTURAL DRAWINGS AND ALL OTHER RELEVANT SERVICES DRAWINGS.
 - REFER TO EL-0-01 FOR LEGEND, GENERAL NOTES AND LIGHT FITTING SCHEDULE.
 - POWER AND COMMUNICATION CONDUITS SHALL BE BORED. ENSURE THAT THE MINIMUM REQUIRED CLEARANCE IS MAINTAINED BETWEEN SERVICES.
 - CABLE PITS WITHIN PATHWAYS SHALL BE FINISHED FLUSH WITH THE FINISHED LEVEL OF THE INSITU CONCRETE, PAVING OR BITUMEN.
 - ALL CONDUITS SHALL BE SEALED TO PREVENT THE INGRESS OF WATER AFTER INSTALLATION OF CABLEING.
 - ALL EQUIPMENT AND ACCESSORIES SHALL BE NEW UNLESS NOTED OTHERWISE.
 - THE ELECTRICAL EQUIPMENT SHOWN ON THE DRAWINGS ARE NOT TO SCALE. FINAL POSITION OF ALL EQUIPMENT TO BE DETERMINED ON SITE PRIOR TO INSTALLATION. REFER TO ARCHITECTURAL FITOUT DRAWINGS.
 - CONDUIT SIZE SHOWN IS REPRESENTATIVE OF THE MINIMUM REQUIREMENT. THE CONTRACTOR MUST SIZE UP TO SUIT THE FINAL CABLE SIZE.
 - CONTRACTOR SHALL ENGAGE WITH TREE ARBORIST TO VALIDATE TPZ (TREE PROTECTION ZONES) WHERE CONDUITS ARE INSTALLED IN CLOSE PROXIMITY AND ADEQUATE PROTECTION SHALL BE PROVIDED TO PREVENT UNDUE DAMAGE TO CONDUITS. EXACT FINAL CONDUIT ROUTES WOULD BE SUBJECT TO SATISFYING ARBORIST REQUIREMENTS.
 - CONTRACTOR SHALL RUN CONDUIT CLOSE TO PATHWAY EDGE. THE CONDUIT RUN DRAWN HERE IS ONLY INDICATIVE. CONTRACTOR TO CONSIDER 500mm BACK OF PATH IN ADDITION TO ABOVE.
 - PROJECT ARBORIST WILL REVIEW ON SITE ALL NEW POLE LOCATIONS SHOWN. DIRECTIONAL BORING FOR UNDERGROUND CONDUITS IS TO OCCUR AT 1000MM DEPTH.

HERITAGE VICTORIA
 ENDORSED DOCUMENT
 Permit No. P-33955
 UNDERGROUND SERVICES NOTES
 09/09/2022
 VHR No. H2252
 File No. -
 SIGNED: [Signature]
 Executive Director
 NOTE: Conditions apply.

D#	POLES	CIRCUIT
ND4	150	L1
ND4	151	L1
ND4	152	L1
ND4	153	L1
ND4	154	L1
ND4	155	L1
ND4	156	L2
ND4	157	L2
ND4	158	L2
ND4	159	L2
ND4	160	L2
ND4	161	L2
ND4	162	L2
ND4	163	L3
ND4	164	L3
ND4	165	L3
ND4	166	L3
ND4	167	L3
ND4	168	L3

WARNING
 BEWARE OF NEW AND EXISTING UNDERGROUND SERVICES

THE LOCATIONS OF NEW AND EXISTING UNDERGROUND SERVICES ARE APPROXIMATE ONLY AND THEIR EXACT POSITION SHOULD BE PROVEN ON SITE. NO GUARANTEE IS GIVEN THAT ALL EXISTING SERVICES ARE SHOWN. IT IS THE CONTRACTORS RESPONSIBILITY TO VERIFY LOCATION AND DEPTH OF ALL NEW AND EXISTING UNDERGROUND SERVICES PRIOR TO CONSTRUCTION WORK. THE CONTRACTOR SHALL VISIT THE SITE TO ASCERTAIN THE TRUE NATURE OF THE WORKS. NO CLAIMS FOR EXTRAS WILL BE ALLOWED FOR THROUGH NEGLIGENCE OF THIS ADVICE. COORDINATE INVERT LEVEL AND LOCATION OF NEW AND EXISTING SERVICES TO AVOID CLASHES WITH STRUCTURAL ELEMENTS AND OTHER SERVICES OF OTHER TRADES BEFORE COMMENCING ANY WORK ON SITE.

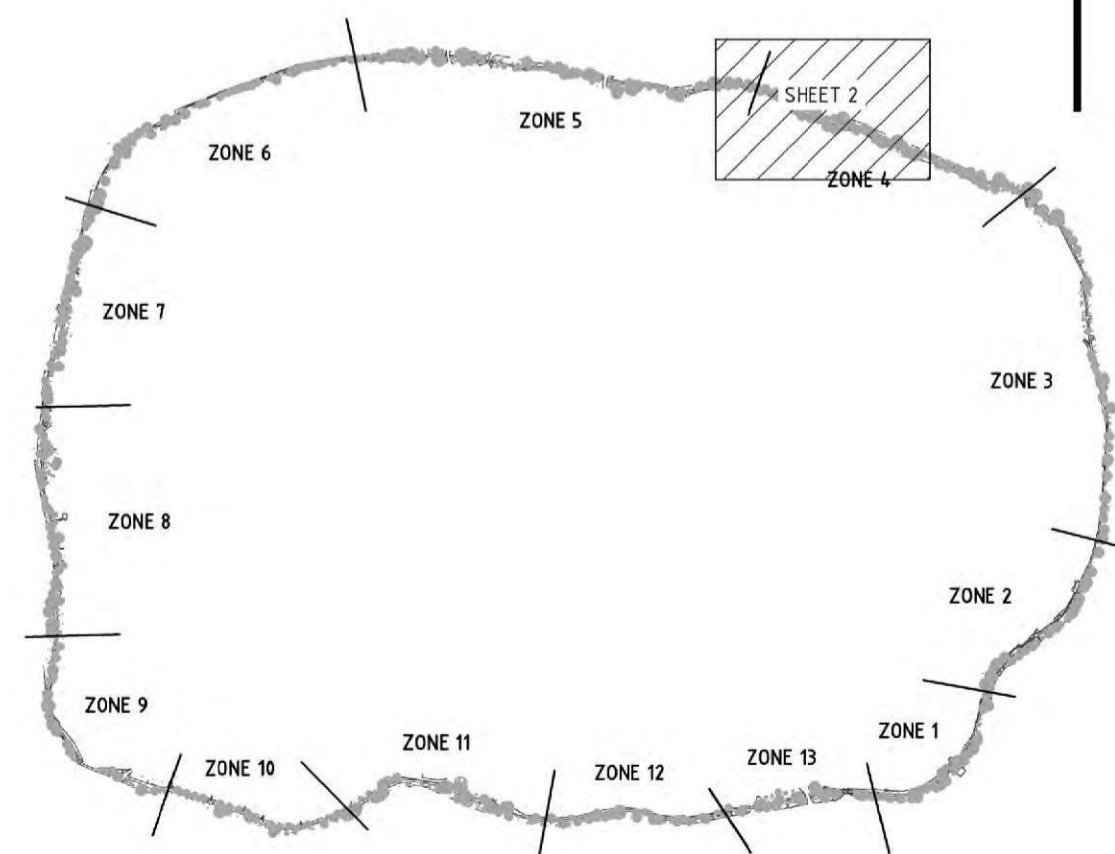

KEY PLAN

REPRODUCTION OF DRAWINGS
 THE DRAWINGS HAVE BEEN DOCUMENTED IN COLOUR. AS SUCH, THE DRAWINGS ARE REQUIRED TO BE PRINTED IN COLOUR. FAILURE TO DO SO MAY RESULT IN LOSS OF INFORMATION. BLACK & WHITE PRINTING MAY BE USED IF SPECIFIC BLACK & WHITE DOCUMENTS HAVE BEEN OBTAINED FROM WGE.

CITY OF BALLARAT

ARCHITECT/CIENT

LAKE WENDOUREE, BALLARAT,
 STEVE MONEGHETTI TRACK
 PUBLIC LIGHTING

ZONE 4 - PROPOSED
 LIGHTING & POWER LAYOUT -
 STAGE 2 SHEET 2

PROJECT TITLE

Stantec CONSTRUCTION ISSUE

ELECTRICAL SERVICES

1:500 45683 EL-2-07 2

SCALE @ A1 PROJECT No DRAWING No REV

REV	DESCRIPTION	DRAWN	APPD	DATE
2	ISSUED FOR CONSTRUCTION	TRS	JPK	07.06.22
1	CONSTRUCTION ISSUE	TRS	JPK	13.04.22

FOR CONTINUATION REFER TO DRAWING EL-2-06 (ZONE 4 - SHEET 1)